



ANCHOR THREAD[®]

safety built in

The Anchor Thread System eliminates the need for drilling into recently poured concrete by providing a cast in place ready to use anchor point immediately upon stripping your formwork. It greatly reduces the hazards of silica dust and ladder time. Save time and labor costs with the Anchor Thread System.



WHAT IS ANCHOR THREAD?

AJUSTCO'S AIM WITH THE ANCHORING PRODUCTS DIVISION IS TO REVOLUTIONIZE THE CONSTRUCTION INDUSTRY THROUGH THE INNOVATIVE PROCESS OPTIMIZATION THAT IS FOSTERED BY THEIR PATENTED PRODUCTS.

ANCHOR THREAD® IS A REVOLUTIONARY, AWARD-WINNING RECESSED CAST-IN-PLACE CONCRETE ANCHORING SYSTEM THAT PROVIDES UNPARALLELED SAFETY, STRENGTH, VERSATILITY, AND RELIABILITY.



The AT-500 Lock-Plate is a recessed, two-step installation model that consists of an anchor bolt assembly and a Lock-Plate, which are mounted to the formwork for the purpose of allowing the anchor bolt assembly to be installed either immediately after the Lock-Plate is fastened or later in the cycle, depending on the requirements of the situation. There are two different mounting options for the Lock-Plate, the included option is the "NLP", which stands for Nailable-Lock-Plate; this model is nailed to wooden formwork with included nails. As an additional line item, we offer the Boltable-Lock-Plate, a metal Lock-Plate that can be bolted to any material formwork with two included 8-32 screws. This saves the repeated measuring and mounting step, further expediting the cycle time of the job while standardizing anchor point positions.



Ajustco
**ANCHOR
THREAD**
safety built in



**ANCHOR THREAD WINS THE
2020 NYC DEPT. OF BUILDINGS
"HACK THE BUILDING CODE"
INNOVATION CHALLENGE**



**ANCHOR THREAD WINS
THE 2021 LIBERTY MUTUAL
SAFETY INNOVATION AWARD**

The Anchor Bolt is offered in several material options; grade-5 zinc-plated-steel (ASTM A325-14) and 316L stainless steel. Currently, we offer a 1/2-13 UNC right-hand-turn thread with several additional thread sizes in development. On the bottom of every anchor bolt is a laser-etched QR code that, when scanned on a smartphone or tablet by the end user, calls up a page displaying product information on the anchoring system, including specifications, lot number, instruction manual, engineered drawings for reference, and the Anchor Thread® ICC-ES evaluation report.

ICC-ES EVALUATION REPORT- [ESR-4788 - AJUSTCO, LLC \(anchoringproducts.com\)](https://www.icces.org/reports/ESR-4788-AJUSTCO-LLC-anchoringproducts.com)



ADVANTAGES OF ANCHOR THREAD

- Ready for Use Immediately Upon Formwork Removal
- No Drilling Required
- 5,000lb (2,268kg) Maximum Workload
- True Code Compliance for Leading-Edge Protection
- Virtually Eliminates Ground Silica Dust
- Cost-Effective
- Expedites Cycle Time
- Reduces Ladder-Time
- Easily Patchable
- Environmentally Friendly



APPLICATIONS

- Personal Fall Arrest System
- Leading-Edge Protection
- Safety Netting
- Debris Netting
- Shaft Netting
- MEPS
- Ceiling Systems
- Building Maintenance Safety Connection Points
- Emergency Evacuation Repel Points
- Architectural Details
- Equipment Tie-Down Point
- Temporary Lighting Connection Point
- Curtain Wall
- Window Wall





PRODUCTS

AT-500 LP

ANCHOR THREAD 316L STAINLESS

White Cap Product#:

263AT500GSS (GREEN)

263AT500YSS (YELLOW)*

263AT500BSS (BLUE)*

263AT500RSS (RED)*

263AT500OSS (ORANGE)*
(Includes standard eye nut)



ANCHOR THREAD 1/2" ZINC

White Cap Product#:

263AT500GZ (GREEN)

263AT500YZ (YELLOW)*

263AT500BZ (BLUE)*

263AT500RZ (RED)*

263AT500OZ (ORANGE)*
(Includes standard eye nut)

• Workload: 5,000lbs. (2,268kgs.) • 50 units per box • Mounting nails included • Removal tools included

* Special order colors for color-coding by trade or BIM standards. † Standard eye nut not rated for personal fall protection included.

ACCESSORIES



1/2" ANCHOR NUT KIT
 White Cap Product#: **263AT500ANKEA**

- Anchor nut workload: 5,000lbs. (2,268kgs.)
- Maximum plate capacity 7/16
- 1 kit per package



1/2" HEAVY DUTY EYE NUT*
 White Cap Product#: **263AT500HDNEA**

- Workload: 5,000lbs.
- ANSI/ASSP Z359.18-2017 TYPET
- 1 HD Eye Nut per Package

* Rated for personal fall protection



1/2" BOLTABLE LOCK PLATE KIT
 White Cap Product#: **263AT500BLP**

- Reusable lock plate for mounting Anchor Thread to formwork
- 25 kits per box



1/2" ANCHOR NUT WRENCH
 White Cap Product#: **263AT500ANWEA**

- Tool makes installation easy and convenient
- 1 per kit



1/2" COLOR CODED RUBBER PLUGS

- Helps keep Anchor Thread cavities clear of debris when not in use
- Color coded for trade and BIM standards
- 50 per box

White Cap Product#:
263AT500RPR (RED)
263AT500RPO (ORANGE)
263AT500RPG (GREEN)
263AT500RPY (YELLOW)
263AT500RPB (BLUE)
263AT500RPGD (GLOW IN DARK)
263AT500RPL (LIMESTONE)

ANCHOR NUT KIT

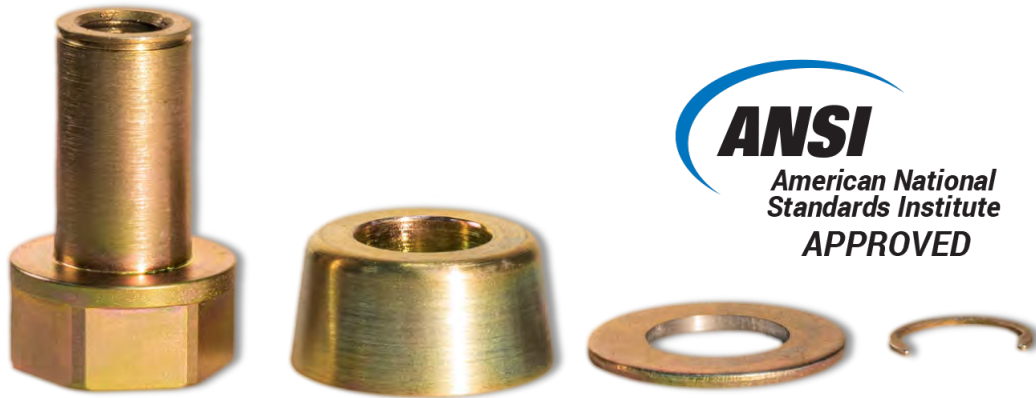

1/2" ANCHOR NUT KIT

White Cap Product#:

263AT500ANKEA

- Anchor nut workload:
5,000lbs. (2,268kgs.)
- Maximum plate capacity 7/16
- 1 kit per package

HD EYENUT



1/2" HEAVY DUTY EYE NUT*

White Cap Product#:

263AT500HDENEA

- Workload: 5,000lbs.
- ANSI/ASSP Z359.18-2017 TYPE T
- 1 HD Eye Nut per Package

* Rated for personal fall protection

ANCHOR NUT WRENCH



1/2" ANCHOR NUT WRENCH

White Cap Product#:

263AT500ANWEA

- Tool makes installation easy and convenient
- 1 per kit

BOLTABLE LOCKPLATE KIT

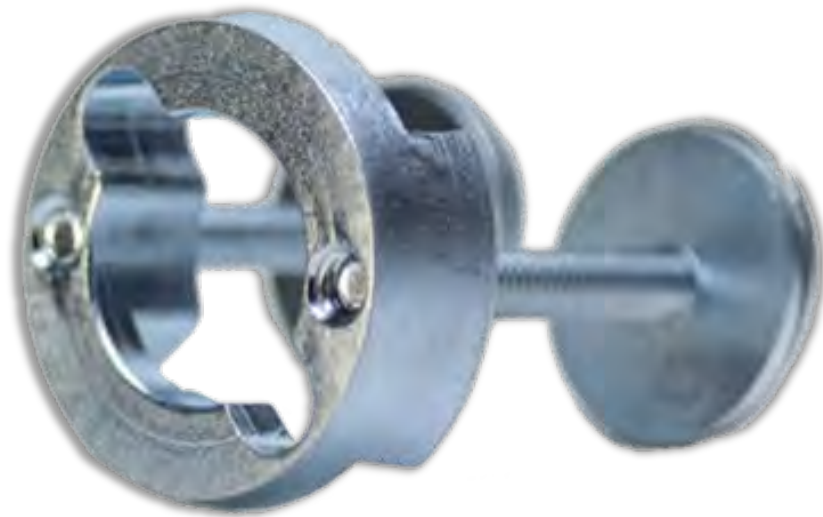

1/2" BOLTABLE LOCK PLATE KIT

White Cap Product#:

263AT500BLP

- Reusable lock plate for mounting Anchor Thread to formwork
- 25 kits per box

RUBBER PLUG

1/2" COLOR CODED RUBBER PLUGS



- Helps keep Anchor Thread cavities clear of debris when not in use
- Color coded for trade and BIM standards
- 50 per box

White Cap Product#:

263AT500RPR (RED)

263AT500RPO (ORANGE)

263AT500RPG (GREEN)

263AT500RPY (YELLOW)

263AT500RPB (BLUE)

263AT500RPGD (GLOW IN DARK)

263AT500RPL (LIMESTONE)

COLUMN INSTALLATION

STEP 1

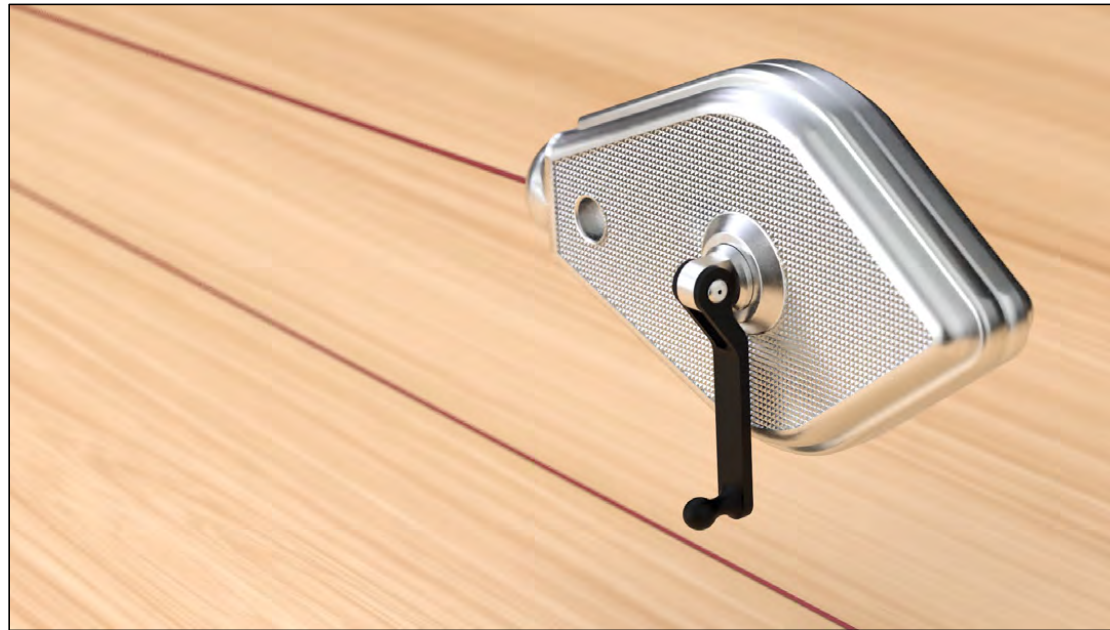

MARK THE DESIRED CENTER OF THE LOCK PLATE LOCATION

COLUMN INSTALLATION

STEP 2

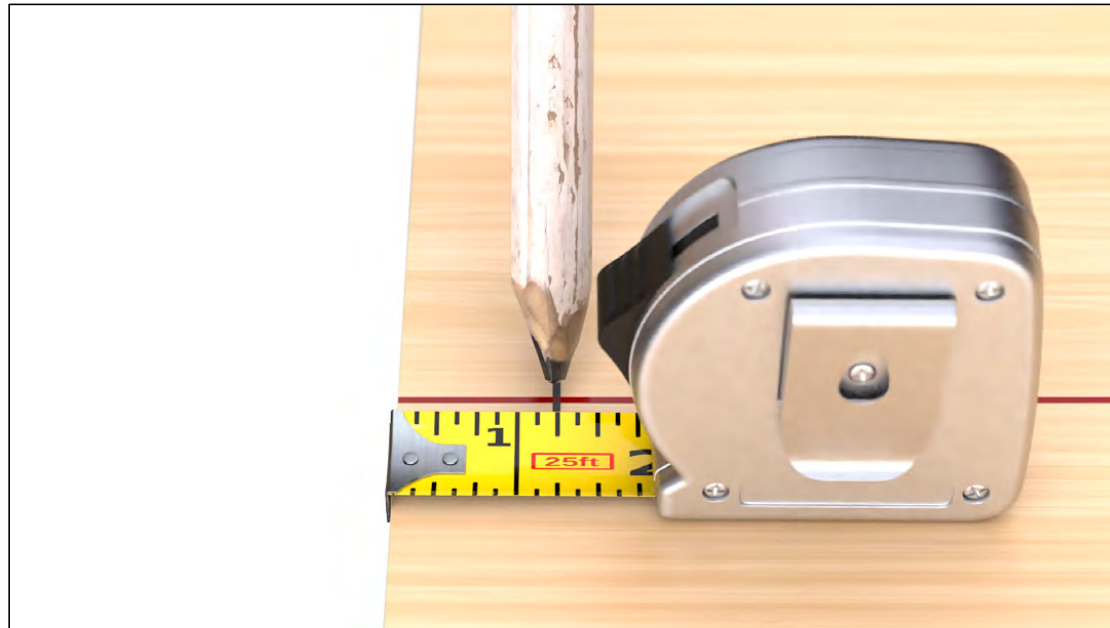

MARK THE HEIGHT OF EACH ANCHOR THREAD

COLUMN INSTALLATION

STEP 3

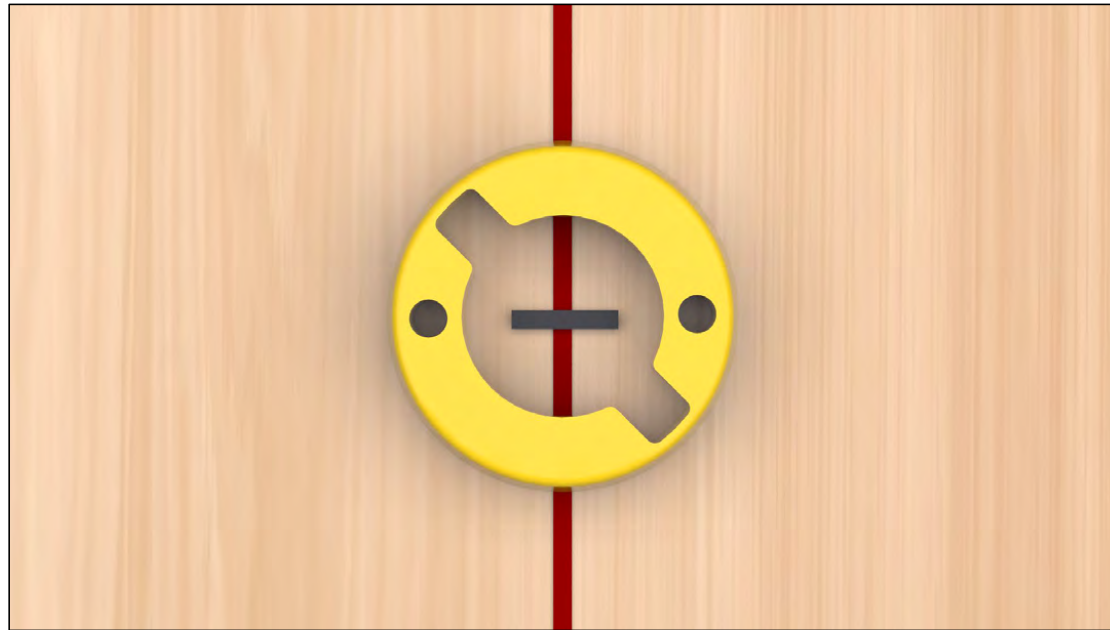

NAIL THE LOCK PLATE TO THE FORMWORK WHERE SPECIFIED

COLUMN INSTALLATION

STEP 4

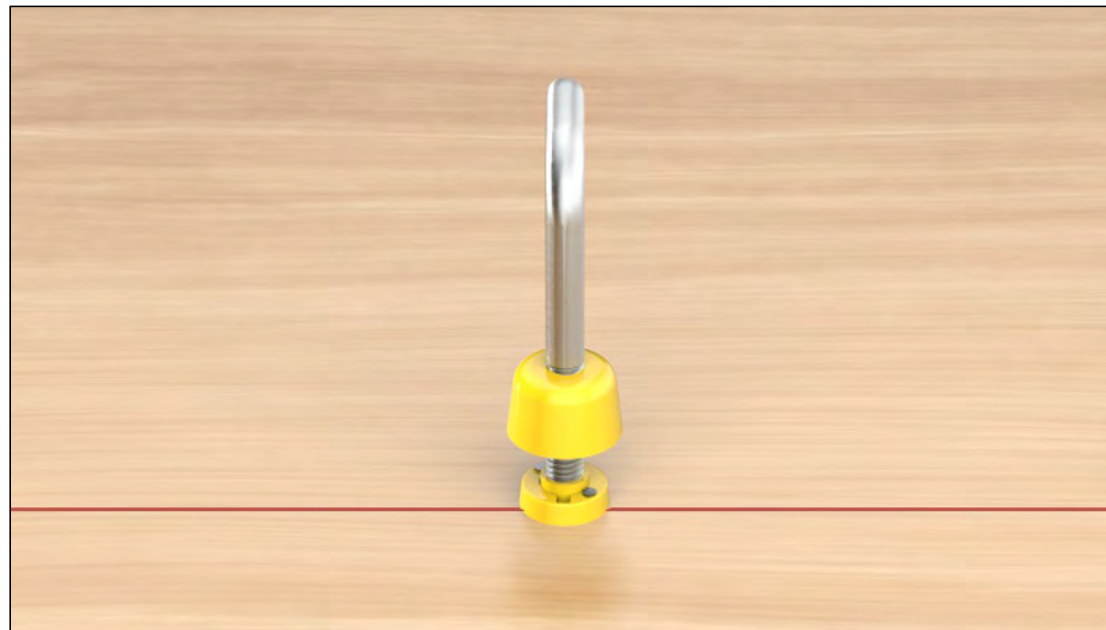

INSERT THE ANCHOR BOLT ASSEMBLY AND TURN 90 DEGREES CLOCKWISE TO LOCK IT IN
***DO NOT TURN PAST 90 DEGREES!**

COLUMN INSTALLATION

STEP 5

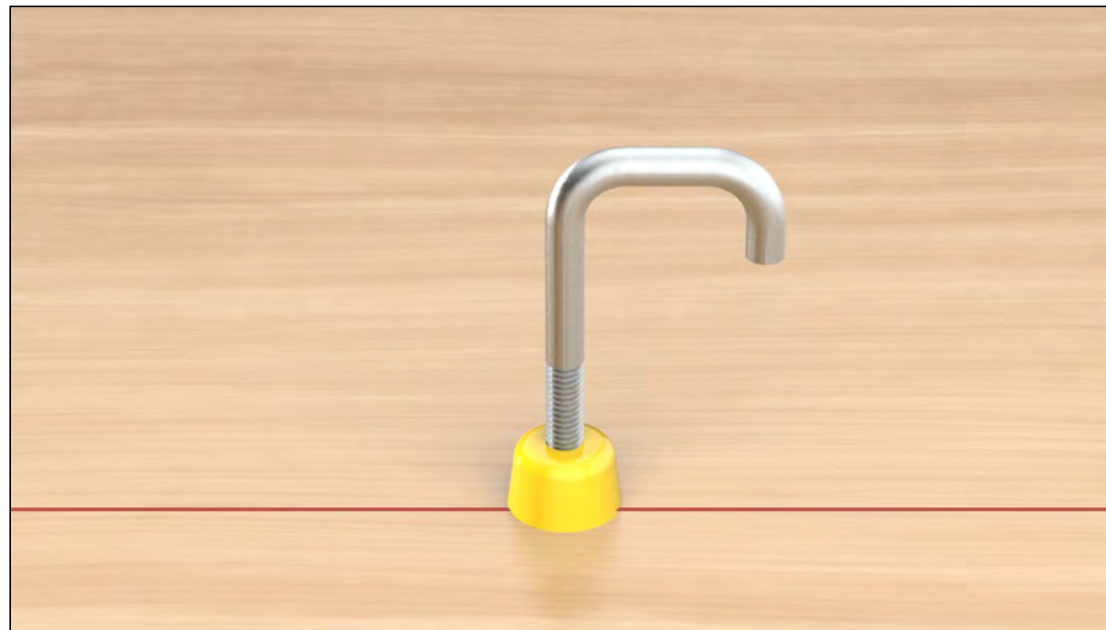

TURN THE ESCUTCHEON CLOCKWISE UNTIL IT IS SNUG AGAINST THE FORMWORK TO SEAL THE ASSEMBLY
***DO NOT OVERTIGHTEN!**

COLUMN INSTALLATION

STEP 6

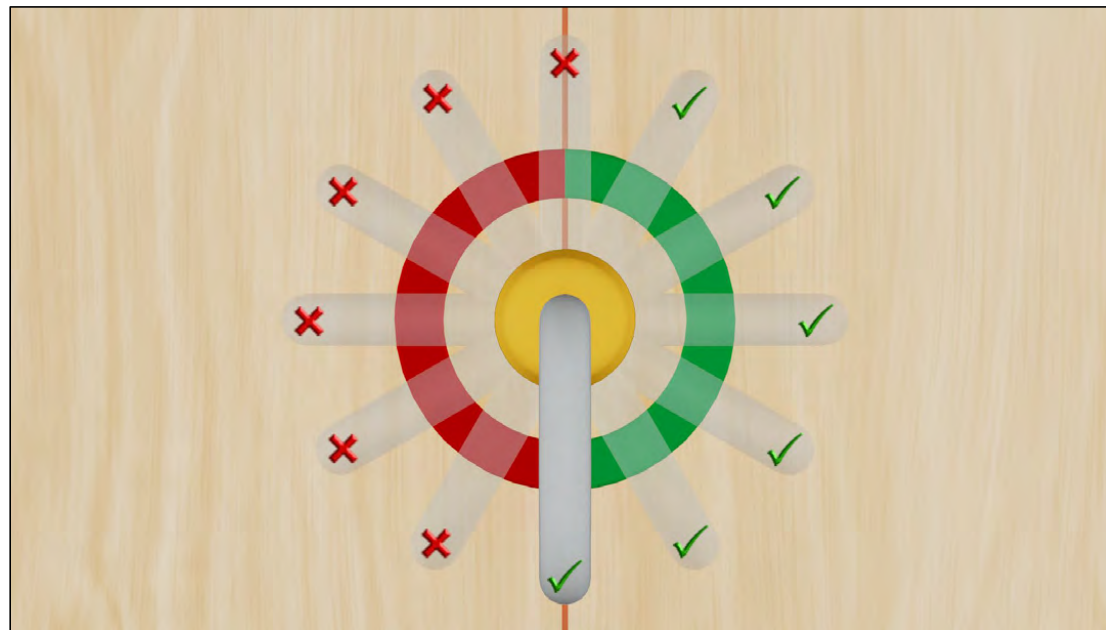

ENSURE THAT THE ANCHOR BOLT IS ORIENTED SUCH THAT THE DOUBLE BEND IS WITHIN THE ACCEPTABLE RANGE AS OUTLINED ABOVE. IF THE ANCHOR BOLT IS NOT ORIENTED WITHIN THE ACCEPTABLE RANGE, REMOVE THE ANCHOR BOLT ASSEMBLY, FLIP IT 180 DEGREES, REINSERT AND TIGHTEN DOWN.

COLUMN INSTALLATION

STEP 7

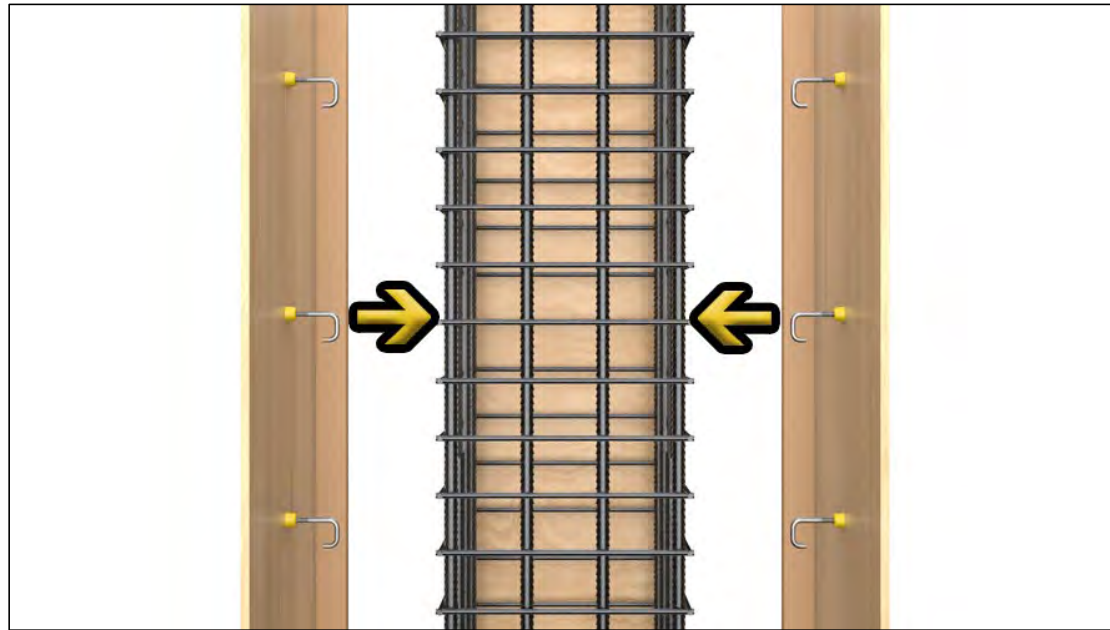

WITH ALL OF THE ANCHOR THREADS INSTALLED YOU ARE READY TO ASSEMBLE THE FORMS

COLUMN INSTALLATION

STEP 8

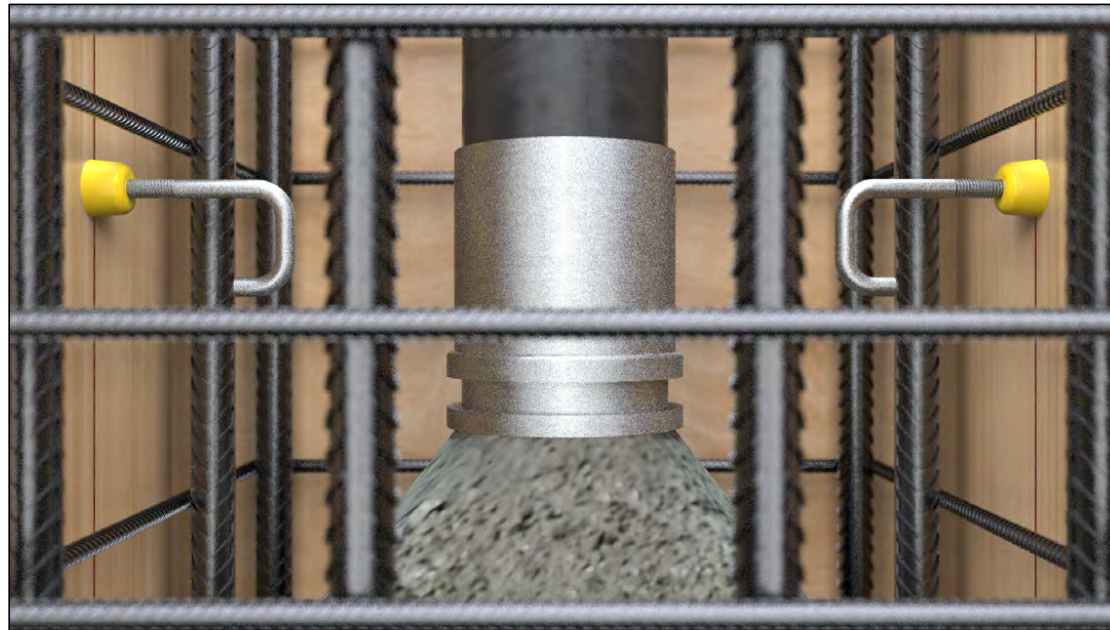

ONCE ALL OF THE FORMS ARE ASSEMBLED YOU ARE READY TO PLACE YOUR CONCRETE

COLUMN INSTALLATION

STEP 9

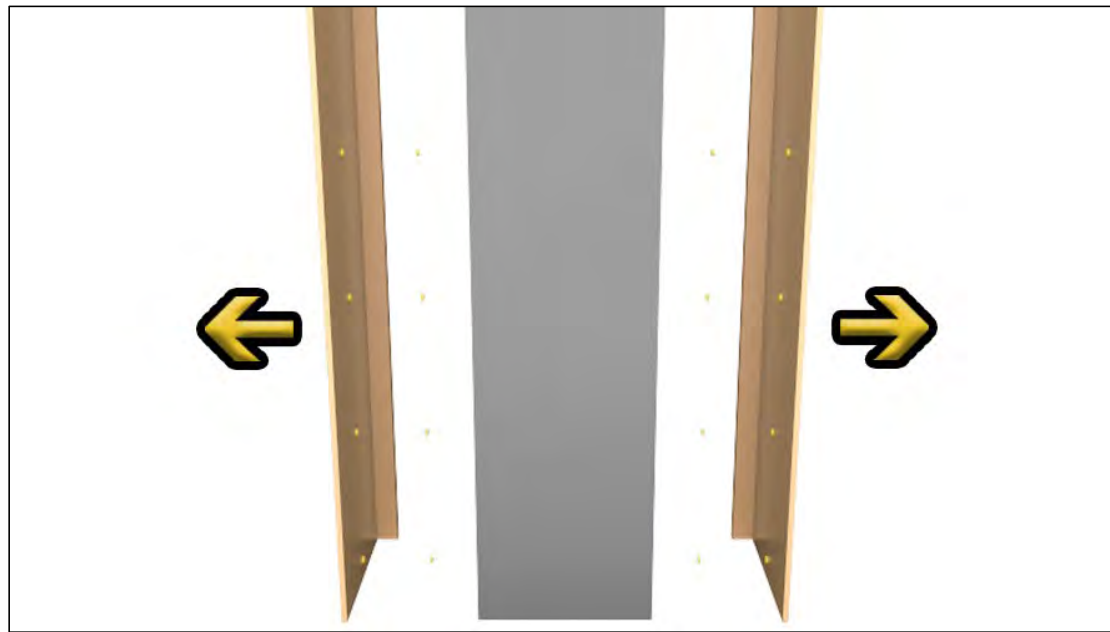

WHEN THE QUALIFIED PERSON CONFIRMS THAT THE CONCRETE HAS ACHIEVED THE REQUIRED STRENGTH, YOU ARE READY TO STRIP THE FORMWORK

COLUMN INSTALLATION

STEP 10

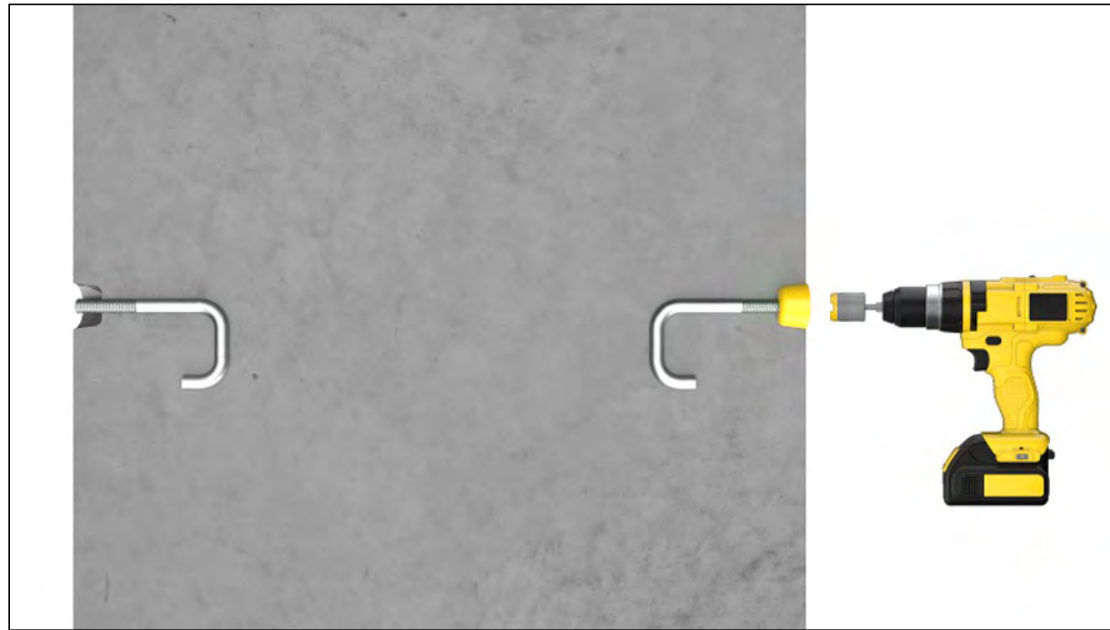

USE THE INCLUDED ESCUTCHEON REMOVAL TOOL TO BACK OUT THE ESCUTCHEON

COLUMN INSTALLATION

STEP 11

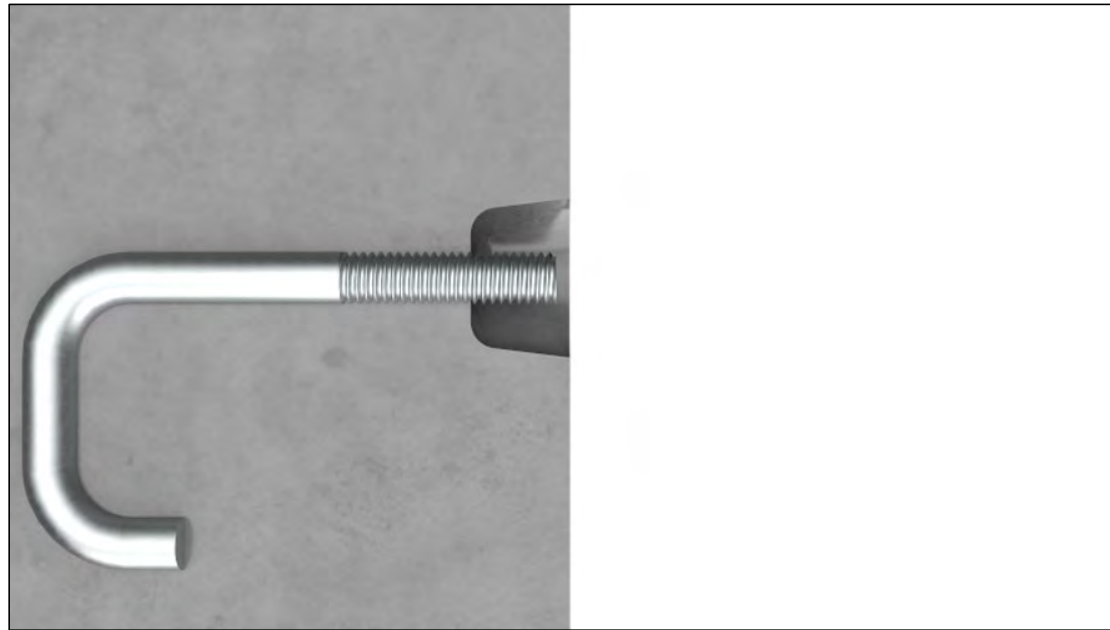

ONCE ALL APPLICABLE INSPECTIONS AND TESTS HAVE BEEN SUCCESSFULLY COMPLETED,
THE ANCHOR THREADS ARE READY TO BE UTILIZED

SLAB INSTALLATION

STEP 1

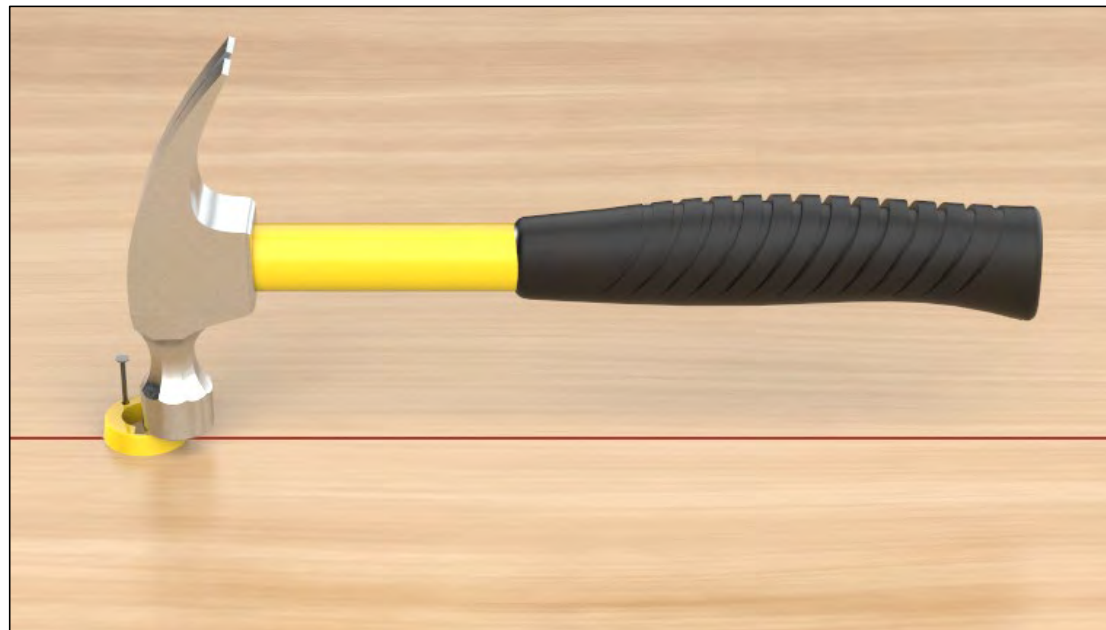

NAIL THE LOCK PLATE TO THE FORMWORK WHERE SPECIFIED

SLAB INSTALLATION

STEP 2

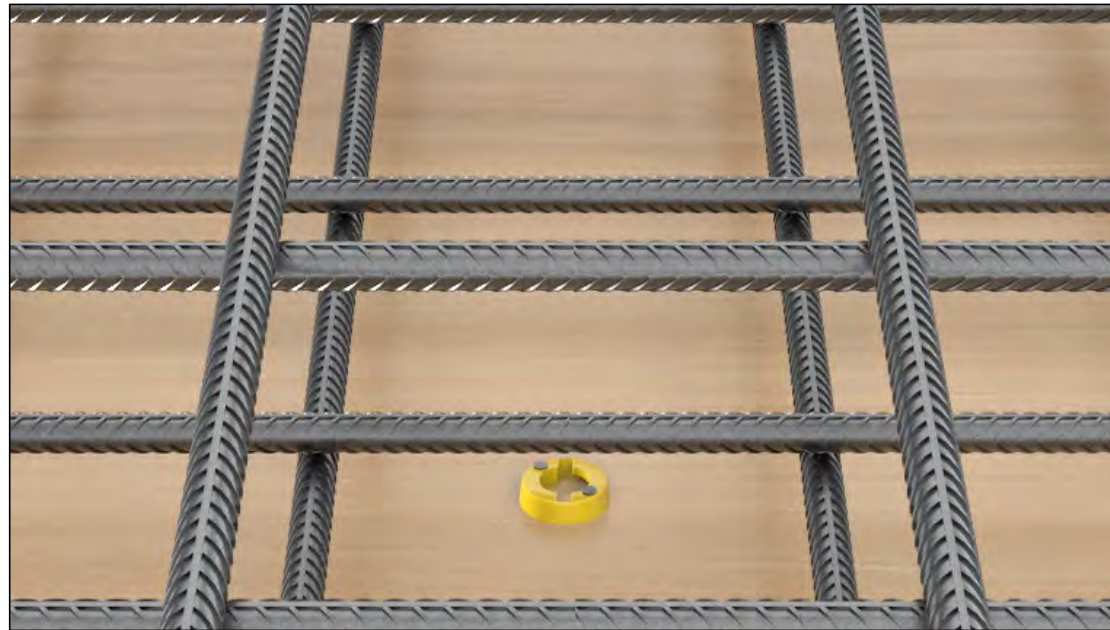

INSTALL THE REINFORCING STEEL

SLAB INSTALLATION

STEP 3



INSERT THE ANCHOR BOLT ASSEMBLY AND TURN 90 DEGREES CLOCKWISE TO LOCK IT IN.
***DO NOT TURN PAST 90 DEGREES!**

SLAB INSTALLATION

STEP 4



TURN THE ESCUTCHEON CLOCKWISE UNTIL IT IS SNUG AGAINST THE FORMWORK TO SEAL THE ASSEMBLY.

***DO NOT OVERTIGHTEN!**

SLAB INSTALLATION

STEP 5



WITH ALL OF THE ANCHOR THREADS INSTALLED YOU ARE READY TO PLACE YOUR CONCRETE

SLAB INSTALLATION

STEP 6

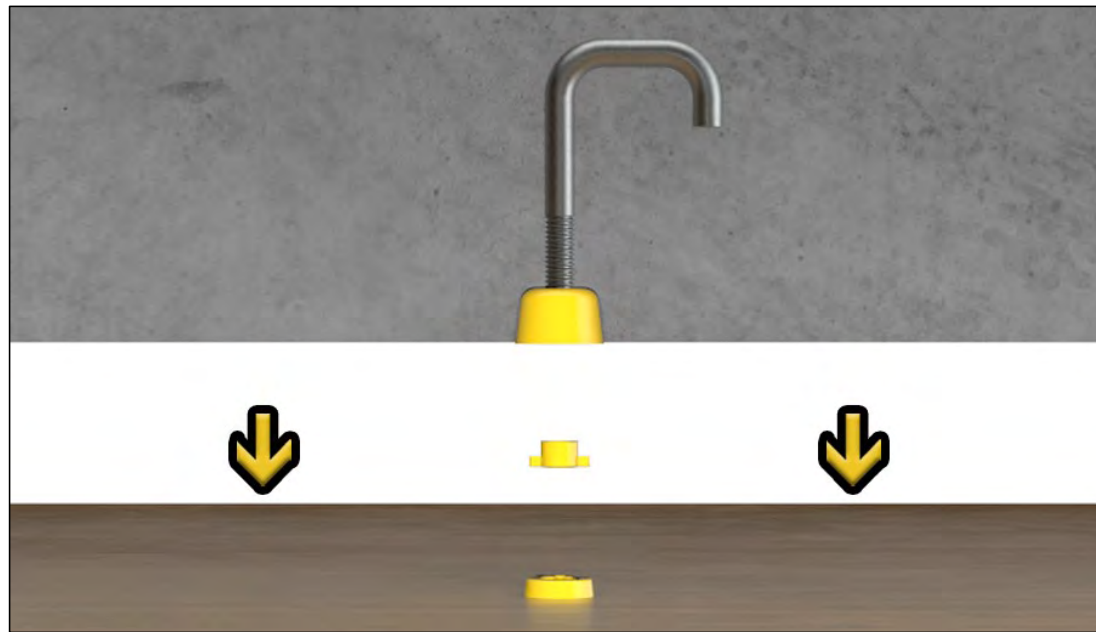

WHEN THE QUALIFIED PERSON CONFIRMS THAT THE CONCRETE HAS ACHIEVED THE REQUIRED STRENGTH, YOU ARE READY TO STRIP THE FORMWORK

SLAB INSTALLATION

STEP 7



USE THE INCLUDED ESCUTCHEON REMOVAL TOOL TO BACK OUT THE ESCUTCHEON

SLAB INSTALLATION

STEP 8

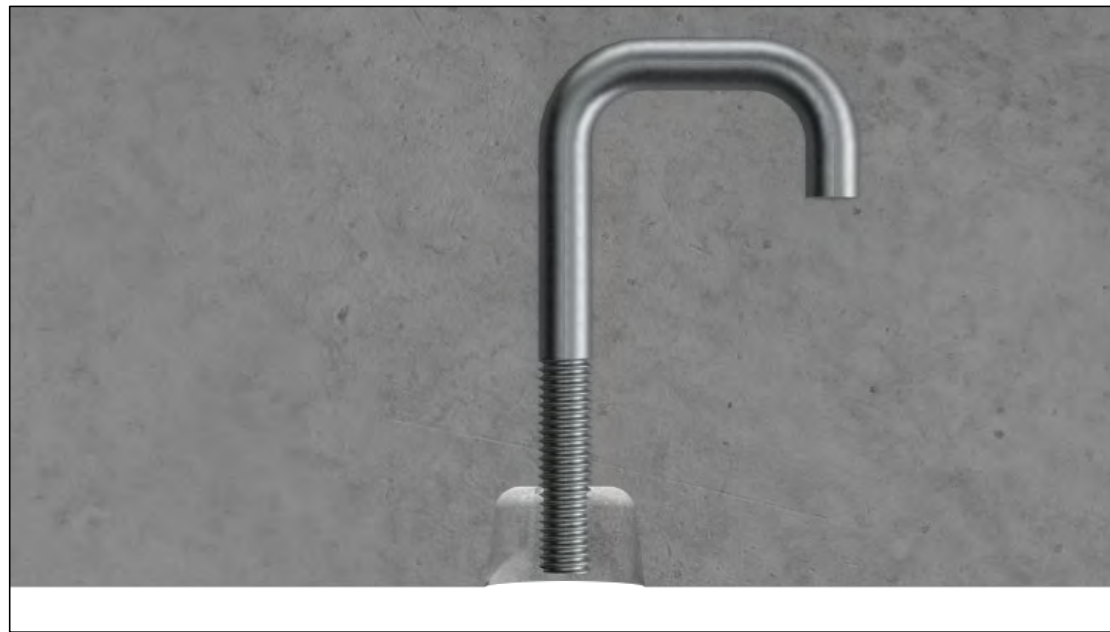

ONCE ALL APPLICABLE INSPECTIONS AND TESTS HAVE BEEN SUCCESSFULLY COMPLETED, THE ANCHOR THREADS ARE READY TO BE UTILIZED

FAQ



Q- Does the orientation of the LOCK-PLATE matter?

A- No, the orientation of the lock-plate doesn't matter because you can remove the bolt and rotate it 180 degrees. The bolt should always be turned from 12 to 6 to be properly secured.

Q- Does the ANCHOR-BOLT have to be tied to the reinforcing steel?

A- No, the ANCHOR THREAD system is completely freestanding.

Q- What is the minimum concrete strength required?

A- 5,000 PSI

FAQ



Q- Is there a strength difference between the different color Anchor Threads?

A- No they're all rated for a 5,000lbs workload per anchor point. These units come in a variety of BIM colors to distinguish their applications.

Q- Can the standard eye-nut be used for fall protection?

A- No it is only permitted for use with cable rail leading edge protection systems.

-Also, the HD Eye-Nut can be used for both applications if you wish to use it for that, but it should never be used for multiple applications simultaneously.

FAQ



Q- What is the minimum slab thickness?

A- 6 IN./15.24 CM.

Q- What size screws are used for the Lock-plate?

A- Thread Size: #8-32 Thread length is determined by adding 3/8IN. or 9.5MM to the thickness of the formwork.

Q- Can Anchor Threads be used for a lifeline?

A- Yes when used with an ANSI approved device such as our HD Eye-Nut or D-Bolt. Since it is an imbed, it is rated for 5,000lbs per point making it a 10,000lb lifeline.

FAQ



Q- Can Anchor Threads be patched?

A- Yes Anchor Threads recessed design makes it easily patchable.

Q- Can Anchor Thread be reused after being subjected to a fall arrest event?

A- No, the Anchor Thread must be decommissioned after a fall arrest event, just like any other personal fall protection equipment.

Q- Can Anchor Threads be used in a vertical installation?

A- Yes it can be used in both vertical and horizontal applications.

Q- Are the plastic components recyclable?

A- Yes, the plastic components can be recycled. Contact your local plastic recycling facility for more information. The plastic components are not intended to be reused.

FAQ



Q- Can Anchor Thread be used in a corrosive environment?

A- Yes, the Anchor Thread is available in 316L stainless steel for optimal corrosion resistance.

Q- What is the service life of the Anchor Thread system?

A- Providing the Anchor Thread is not subjected to a fall arrest event, the Anchor Thread system can be used for the structure's life cycle.

Q-Does the HD Eye-Nut need to be tightened to a specific torque rating?

A- No, the HD Eye-Nut is designed to have double the maximum thread depth when hand tight, it is recommended to tighten a quarter to a half turn past hand tight maximum.

FAQ



Q- Why would I use Anchor Thread over other embedded anchoring systems?

A- There are many reasons to choose Anchor Thread.

-Anchor Thread is far stronger, which allows it to also be used for many applications including, but not limited to, fall protection, leading edge protection, safety and debris netting as well as MEPS, making it an outstandingly versatile anchoring system.

-Anchor Thread's recessed design enables it to be patchable.

-The recyclable plastic components are offered in a variety of colors for the purpose of visually identifying a given company or application that the Anchor Thread is intended for.

FAQ



Q- Why would I use Anchor Thread over other embedded anchoring systems?

A- There are many reasons to choose Anchor Thread.

(continued)

- The Lock-Plate (LP) model of the Anchor Thread product line is designed to be installed in a two-step process. The purpose of this is to have the low-profile lock plate mounted before the reinforcing steel is installed; this acts as a visual indicator to the lathers of where not to have steel intersect and prevents the Anchor Thread from being damaged during that process. Once the reinforcing steel is installed, the second step of the Anchor Thread LP installation process is to install the anchor bolt assembly. Upon completion, the Anchor Threads are ready for concrete placement, giving them optimal reliability and ease of installation.

FAQ



Q- What is the cost difference compared to previous methodologies and technologies?

A- When comparing the two technologies, there are a few things to consider. While the unit cost may be higher for the Anchor Thread than other anchors, the labor savings are tremendous. The versatility, consistency, and reliability of the Anchor Thread system reduce the waste of time and material associated with the old methods of anchoring into concrete. The hard and soft cost benefits of the Anchor Thread system supremely outperform the competition. Most Anchors are not certified for fall protection; this requires you to purchase and store multiple different products to work respectively for safety and operations. Anchor Thread allows its customers to use it for all concrete anchoring applications within the 5,000lb per point specification. This minimizes overhead and simplifies logistics.